

BOYNE FALLS PUBLIC SCHOOL

FLOORING REPLACEMENT

1662 M-75 SOUTH; BOYNE FALLS, MI 49713

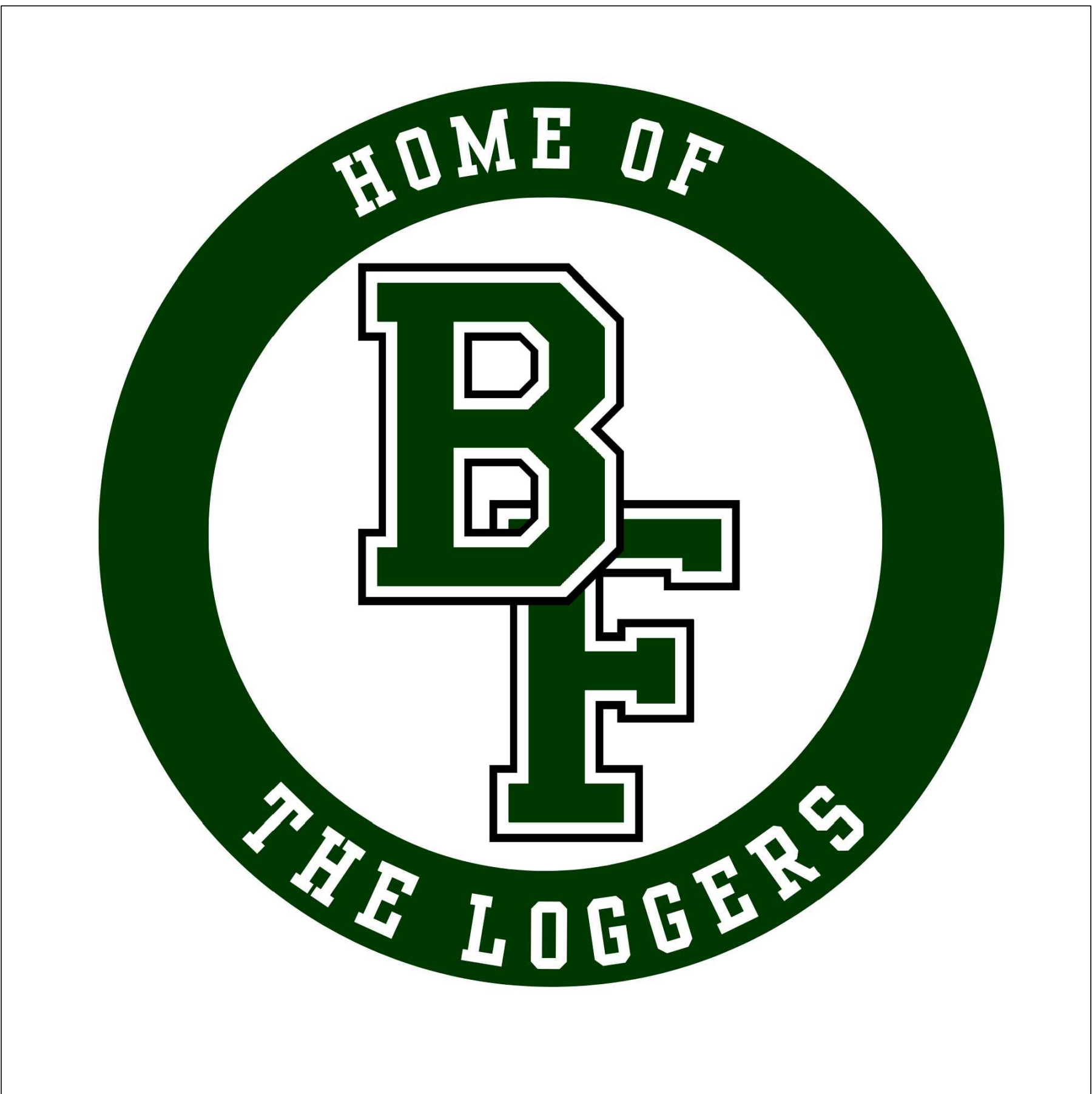

PROJECT CONTACTS
<p>OWNER: BOYNE FALLS PUBLIC SCHOOL DISTRICT 1662 M-75 SOUTH BOYNE FALLS, MI 49713 CONTACT: CYNTHIA PINEDA, SUPERINTENDENT EMAIL: cpineda@boynefalls.org TELEPHONE: 231-549-2211</p> <p>ARCHITECT: ANTHONY ESSON, ARCHITECT MAILING ADDRESS: PO BOX 479 GAYLORD, MI 49734 SHIPPING ADDRESS: 2111 FORESTER DRIVE FREDERIC, MI 49733 CONTACT: ANTHONY ESSON EMAIL: tony@anthonyessonarchitect.com TELEPHONE: 989-358-1927</p> <p>CONSTRUCTION MANAGER: SUGAR CONSTRUCTION, INC. 2968 VENTURE DRIVE MIDLAND, MI 48840 CONTACT: JERRY BROWN EMAIL: jerrybrown@sugarconstruction.com TELEPHONE: 989-941-1221</p>

BUILDING DATA
<p>SITE ADDRESS: BOYNE FALLS PUBLIC SCHOOL 1662 M-75 SOUTH BOYNE FALLS, MI 49713</p> <p>APPLICABLE CODES: 2021 MICHIGAN REHABILITATION CODE 2021 MICHIGAN BUILDING CODE 2012 NFPA 101 LIFE SAFETY CODE</p> <p>USE AND OCCUPANCY CLASSIFICATION: EXISTING USE GROUP E - EDUCATIONAL</p> <p>CONSTRUCTION TYPE: EXISTING MBC TYPE 2B, NFPA TYPE II-000</p> <p>CLASSIFICATION OF WORK: FLOORING REPLACEMENT - LEVEL 1 ALTERATION</p> <p>EXISTING BUILDING AREA: TOTAL BUILDING - 70,540 sf FLOORING REPLACEMENT WORK AREA - 43,066 sf</p>

BID ALTERNATES
<p>BID ALTERNATE NO. 1 - TILE LOGO: BASE BID: FURNISH AND INSTALL FLOOR TILE IN DESIGNATED PATTERN WITHOUT LOGO IN CORRIDOR 101. ALTERNATE BID: FURNISH AND INSTALL WATER-JET CUT TILE LOGO (SEE ABOVE) IN CORRIDOR 101 AS INDICATED.</p>

SHEET INDEX
<p>T TITLE SHEET D0.1 COMPOSITE FLOOR PLAN - EXISTING D1.1 FLOOR PLAN PART "A" - DEMOLITION D1.2 FLOOR PLAN PART "B" - DEMOLITION D1.3 FLOOR PLAN PART "C" - DEMOLITION D1.4 FLOOR PLAN PART "D" - DEMOLITION A0.1 COMPOSITE FLOOR PLAN / ROOM FINISH SCHEDULE A1.1 FLOOR PLAN PART "A" - NEW WORK A1.2 FLOOR PLAN PART "B" NEW WORK A1.3 FLOOR PLAN PART "C" - NEW WORK A1.4 FLOOR PLAN PART "D" - NEW WORK</p>

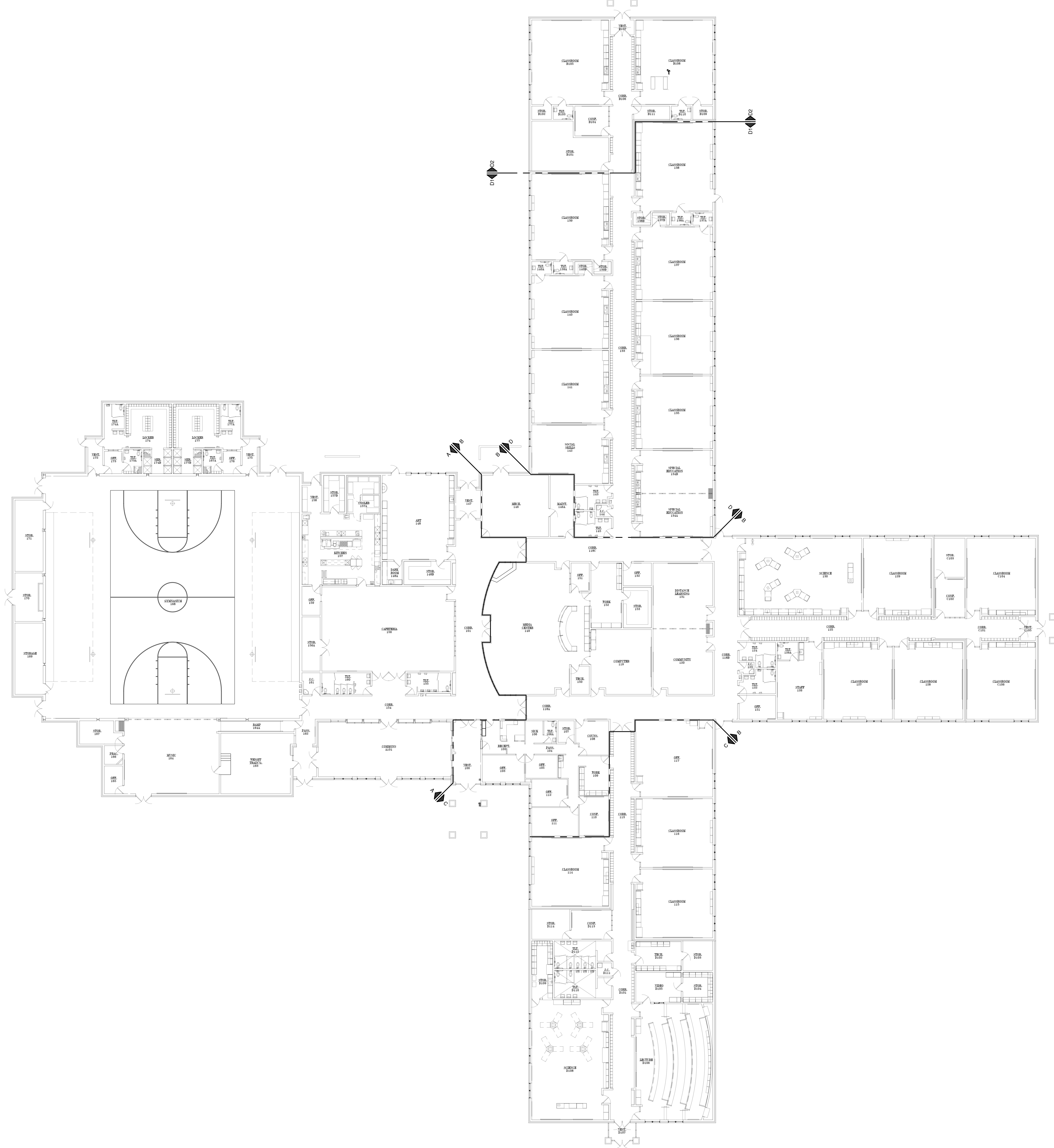

COMPOSITE FLOOR PLAN - EXISTING

SCALE: 1" = 20'-0"

SHEET
D0.1

DATE
JUNE 5, 2028

PROJECT NO.
304-26A

PROJECT TITLE
PROPOSED FLOORING REPLACEMENT FOR:
BOYNE FALLS PUBLIC SCHOOL
BOYNE FALLS, MICHIGAN

DRAWING TITLE
COMPOSITE FLOOR PLAN - EXISTING



ANTHONY P. ESSON
ARCHITECT
PO BOX 479
GAYLORD, MICHIGAN
TELEPHONE: (989) 732-0585

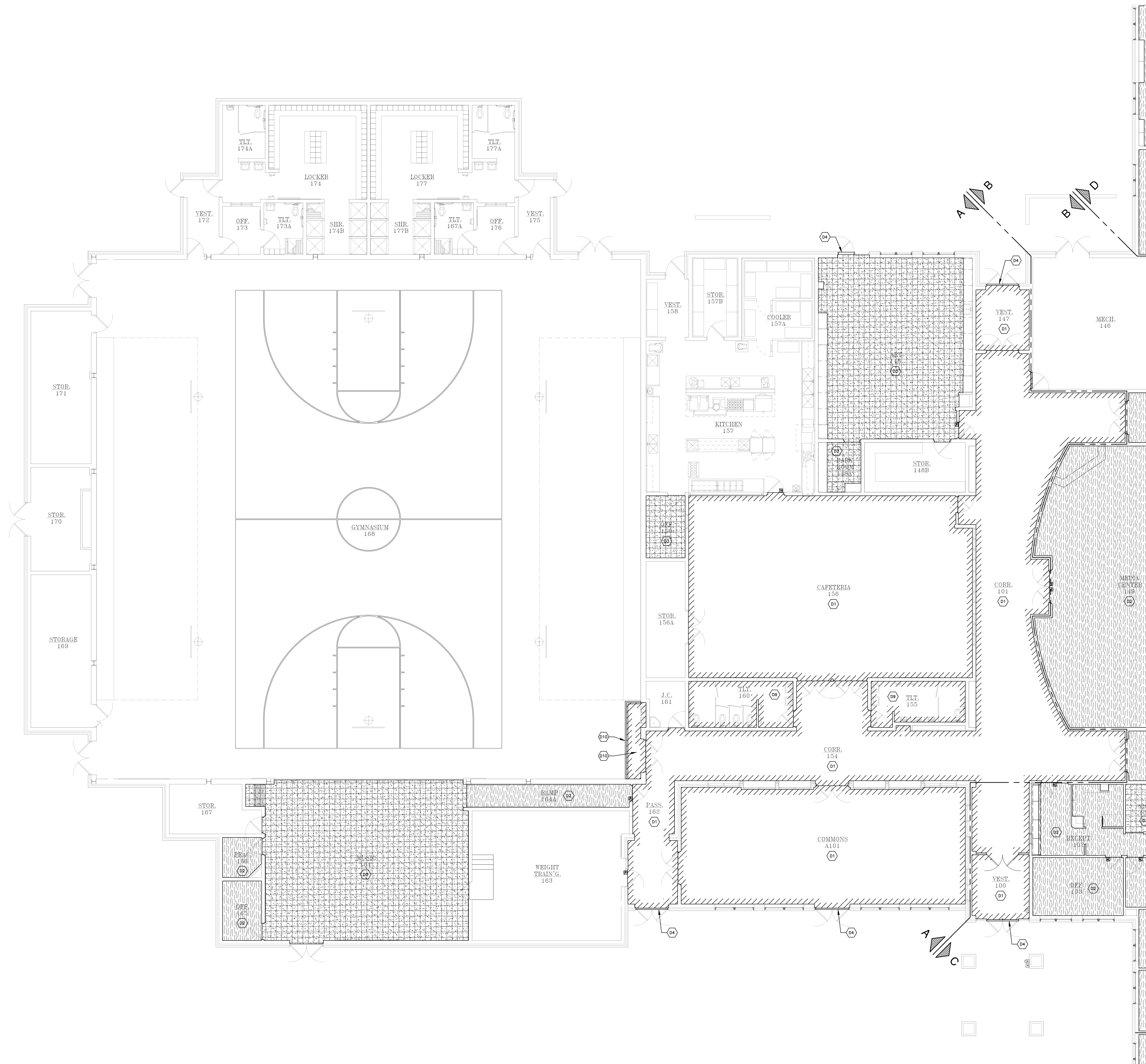

GENERAL DEMOLITION NOTES

REMOVE EX'G ASSEMBLIES TO THE EXTENT REQUIRED FOR THE INSTALLATION OF NEW WORK, AND TO ALLOW FOR CONNECTION OF NEW WORK TO EX'G ADJACENT CONSTRUCTION. KEYED DEMOLITION NOTES ARE GENERAL IN NATURE. ALL EX'G CONDITIONS ARE TO BE FIELD VERIFIED. CONTRACTOR SHALL MAKE NECESSARY ADJUSTMENTS TO DEMOLITION AS REQ'D TO ACHIEVE THE OVERALL DESIGN INTENT.

CONTRACTOR SHALL SALVAGE AND REMOVE EX'G. NIGHT-LOCK DEVICES FOR REINSTALLATION, WHERE PRESENT IN ROOMS SUBJECT TO FLOORING REMOVAL.

CONTRACTOR SHALL REMOVE EX'G FLOORING AND WALL BASE FINISHES AND TRANSITIONS AS REQ'D TO ALLOW FOR THE INSTALLATION OF NEW FINISHES AND TRANSITIONS AS NOTED.

KEYED DEMOLITION NOTES

- (D1) REMOVE EX'G. CERAMIC TILE, WALL BASE, AND ACCESSORY TRANSITIONS. EX'G. MUD SET SUB-BASE (IF ANY) TO REMAIN.
- (D2) REMOVE EX'G. SHEET CARPETING, RESILIENT WALL BASE, AND ACCESSORY TRANSITIONS.
- (D3) REMOVE EX'G. VCT, RESILIENT WALL BASE, AND ACCESSORY TRANSITIONS.
- (D4) REMOVE EX'G. THRESHOLD.
- (D5) REMOVE EX'G. CERAMIC FLOOR TILE AND ACCESSORY TRANSITIONS. EX'G. CERAMIC WALL BASE AND WAINSCOT TO REMAIN. EX'G. MUD SET SUB-BASE (IF ANY) TO REMAIN.
- (D6) REMOVE EX'G. CERAMIC FLOOR TILE AND ACCESSORY TRANSITIONS. EX'G. MUD SET SUB-BASE (IF ANY) TO REMAIN.
- (D7) REMOVE EX'G. CERAMIC FLOOR TILE AND ACCESSORY TRANSITIONS, AND RESILIENT WALL BASE. MUD-SET (IF ANY) TO REMAIN.
- (D8) REMOVE EX'G. SHEET CARPETING, VCT, RESILIENT WALL BASE, AND ACCESSORY TRANSITIONS.
- (D9) REMOVE EX'G. CERAMIC FLOOR TILE AND COVE BASE, AND ACCESSORY TRANSITIONS. EX'G. CERAMIC WAINSCOT ABOVE COVE BASE TO REMAIN. EX'G. MUD SET SUB-BASE (IF ANY) TO REMAIN.
- (D10) SALVAGE AND REMOVE EX'G. ALUMINUM THRESHOLD FOR REINSTALLATION AFTER NEW FLOORING.
- (D11) SALVAGE AND REMOVE EX'G. COMPOSITE WALL ANGLE FOR REINSTALLATION AFTER NEW FLOORING. REMOVE EX'G. CERAMIC FLOOR TILE AND BASE. EX'G. MUD SET SUB-BASE (IF ANY) TO REMAIN.

FLOORING DEMOLITION LEGEND

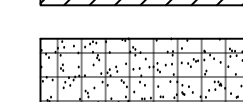
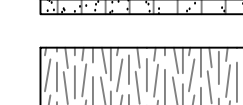
-  REMOVE CERAMIC TILE AND BASE - SEE KEYNOTES FOR SPECIFIC INSTRUCTIONS.
-  REMOVE VCT AND BASE - SEE KEYNOTES FOR SPECIFIC INSTRUCTIONS.
-  REMOVE SHEET CARPET AND BASE - SEE KEYNOTES FOR SPECIFIC INSTRUCTIONS.

FLOOR PLAN PART "A" - DEMOLITION
 SCALE: 1/8" = 1'-0"

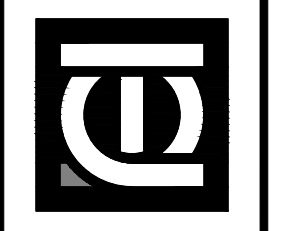



KEYED DEMOLITION NOTES

- (D1) REMOVE EX'G. CERAMIC TILE, WALL BASE, AND ACCESSORY TRANSITIONS. EX'G. MUD SET SUB-BASE (IF ANY) TO REMAIN.
- (D2) REMOVE EX'G. SHEET CARPETING, RESILIENT WALL BASE, AND ACCESSORY TRANSITIONS.
- (D3) REMOVE EX'G. VCT, RESILIENT WALL BASE, AND ACCESSORY TRANSITIONS.
- (D4) REMOVE EX'G. THRESHOLD.
- (D5) REMOVE EX'G. CERAMIC FLOOR TILE AND ACCESSORY TRANSITIONS. EX'G. CERAMIC WALL BASE AND WAINSCOT TO REMAIN. EX'G. MUD SET SUB-BASE (IF ANY) TO REMAIN.
- (D6) REMOVE EX'G. CERAMIC FLOOR TILE AND ACCESSORY TRANSITIONS. EX'G. MUD SET SUB-BASE (IF ANY) TO REMAIN.
- (D7) REMOVE EX'G. CERAMIC FLOOR TILE AND ACCESSORY TRANSITIONS, AND RESILIENT WALL BASE. MUD-SET (IF ANY) TO REMAIN.
- (D8) REMOVE EX'G. SHEET CARPETING, VCT, RESILIENT WALL BASE, AND ACCESSORY TRANSITIONS.
- (D9) REMOVE EX'G. CERAMIC FLOOR TILE AND COVE BASE, AND ACCESSORY TRANSITIONS. EX'G. CERAMIC WAINSCOT ABOVE COVE BASE TO REMAIN. EX'G. MUD SET SUB-BASE (IF ANY) TO REMAIN.
- (D10) SALVAGE AND REMOVE EX'G. ALUMINUM THRESHOLD FOR REINSTALLATION AFTER NEW FLOORING.
- (D11) SALVAGE AND REMOVE EX'G. COMPOSITE WALL ANGLE FOR REINSTALLATION AFTER NEW FLOORING. REMOVE EX'G. CERAMIC FLOOR TILE AND BASE. EX'G. MUD SET SUB-BASE (IF ANY) TO REMAIN.

GENERAL DEMOLITION NOTES

REMOVE EX'G. ASSEMBLIES TO THE EXTENT REQUIRED FOR THE INSTALLATION OF NEW WORK, AND TO ALLOW FOR CONNECTION OF NEW WORK TO EX'G. ADJACENT CONSTRUCTION. KEYED DEMOLITION NOTES ARE GENERAL IN NATURE. ALL EX'G. CONDITIONS ARE TO BE FIELD VERIFIED. CONTRACTOR SHALL MAKE NECESSARY ADJUSTMENTS TO DEMOLITION AS REQ'D TO ACHIEVE THE OVERALL DESIGN INTENT.

CONTRACTOR SHALL SALVAGE AND REMOVE EX'G. NIGHT-LOCK DEVICES FOR REINSTALLATION, WHERE PRESENT IN ROOMS SUBJECT TO FLOORING REMOVAL.

CONTRACTOR SHALL REMOVE EX'G. FLOORING AND WALL BASE FINISHES AND TRANSITIONS AS REQ'D TO ALLOW FOR THE INSTALLATION OF NEW FINISHES AND TRANSITIONS AS NOTED.

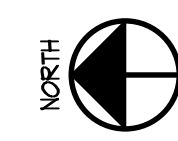

FLOOR PLAN PART "B" - DEMOLITION

SCALE: 1/4" = 1'-0"

FLOORING DEMOLITION LEGEND

- REMOVE CERAMIC TILE AND BASE - SEE KEYNOTES FOR SPECIFIC INSTRUCTIONS.
- REMOVE VCT AND BASE - SEE KEYNOTES FOR SPECIFIC INSTRUCTIONS.
- REMOVE SHEET CARPET AND BASE - SEE KEYNOTES FOR SPECIFIC INSTRUCTIONS.

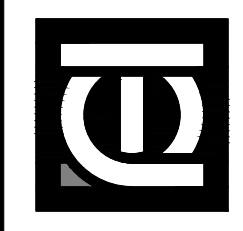



GENERAL DEMOLITION NOTES

REMOVE EX'G ASSEMBLIES TO THE EXTENT REQUIRED FOR THE INSTALLATION OF NEW WORK, AND TO ALLOW FOR CONNECTION OF NEW WORK TO EX'G ADJACENT CONSTRUCTION. KEYED DEMOLITION NOTES ARE GENERAL IN NATURE. ALL EX'G CONDITIONS ARE TO BE FIELD VERIFIED. CONTRACTOR SHALL MAKE NECESSARY ADJUSTMENTS TO DEMOLITION AS REQ'D TO ACHIEVE THE OVERALL DESIGN INTENT.



CONTRACTOR SHALL SALVAGE AND REMOVE EX'G. NIGHT-LOCK DEVICES FOR REINSTALLATION, WHERE PRESENT IN ROOMS SUBJECT TO FLOORING REMOVAL.

CONTRACTOR SHALL REMOVE EX'G FLOORING AND WALL BASE FINISHES AND TRANSITIONS AS REQ'D TO ALLOW FOR THE INSTALLATION OF NEW FINISHES AND TRANSITIONS AS NOTED.

KEYED DEMOLITION NOTES

- 01 REMOVE EX'G. CERAMIC TILE, WALL BASE, AND ACCESSORY TRANSITIONS. EX'G. MUD SET SUB-BASE (IF ANY) TO REMAIN.
- 02 REMOVE EX'G. SHEET CARPETING, RESILIENT WALL BASE, AND ACCESSORY TRANSITIONS.
- 03 REMOVE EX'G. VCT, RESILIENT WALL BASE, AND ACCESSORY TRANSITIONS.
- 04 REMOVE EX'G. THRESHOLD.
- 05 REMOVE EX'G. CERAMIC FLOOR TILE AND ACCESSORY TRANSITIONS. EX'G. CERAMIC WALL BASE AND WANSCOT TO REMAIN. EX'G. MUD SET SUB-BASE (IF ANY) TO REMAIN.
- 06 REMOVE EX'G. CERAMIC FLOOR TILE AND ACCESSORY TRANSITIONS. EX'G. MUD SET SUB-BASE (IF ANY) TO REMAIN.
- 07 REMOVE EX'G. CERAMIC FLOOR TILE AND ACCESSORY TRANSITIONS, AND RESILIENT WALL BASE. MUD-SET (IF ANY) TO REMAIN.
- 08 REMOVE EX'G. SHEET CARPETING, VCT, RESILIENT WALL BASE, AND ACCESSORY TRANSITIONS.
- 09 REMOVE EX'G. CERAMIC FLOOR TILE AND COVE BASE, AND ACCESSORY TRANSITIONS. EX'G. CERAMIC WANSCOT ABOVE COVE BASE TO REMAIN. EX'G. MUD SET SUB-BASE (IF ANY) TO REMAIN.
- 10 SALVAGE AND REMOVE EX'G. ALUMINUM THRESHOLD FOR REINSTALLATION AFTER NEW FLOORING.
- 11 SALVAGE AND REMOVE EX'G. COMPOSITE WALL ANGLE FOR REINSTALLATION AFTER NEW FLOORING. REMOVE EX'G. CERAMIC FLOOR TILE AND BASE. EX'G. MUD SET SUB-BASE (IF ANY) TO REMAIN.

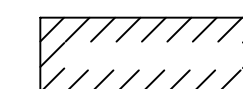
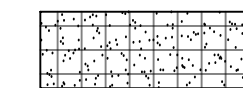
FLOORING DEMOLITION LEGEND

-  REMOVE CERAMIC TILE AND BASE - SEE KEYNOTES FOR SPECIFIC INSTRUCTIONS.
-  REMOVE VCT AND BASE - SEE KEYNOTES FOR SPECIFIC INSTRUCTIONS.
-  REMOVE SHEET CARPET AND BASE - SEE KEYNOTES FOR SPECIFIC INSTRUCTIONS.

FLOOR PLAN PART "C" - DEMOLITION
 SCALE: 1/8" = 1'-0"

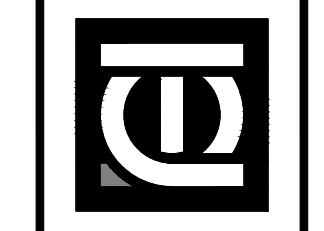

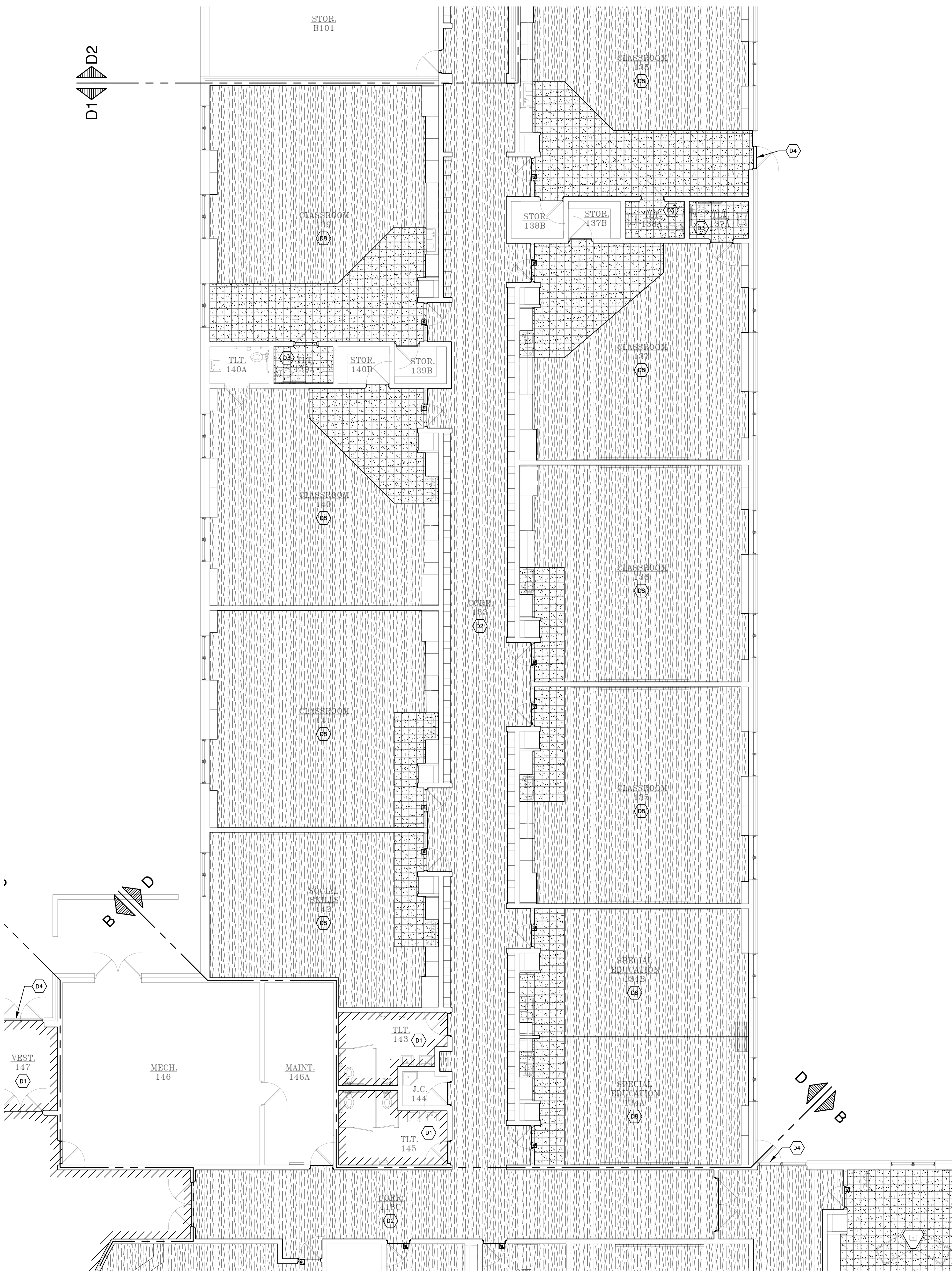

FLOOR PLAN PART "D1" - DEMOLITION



SCALE:

1/8" = 1'-0"

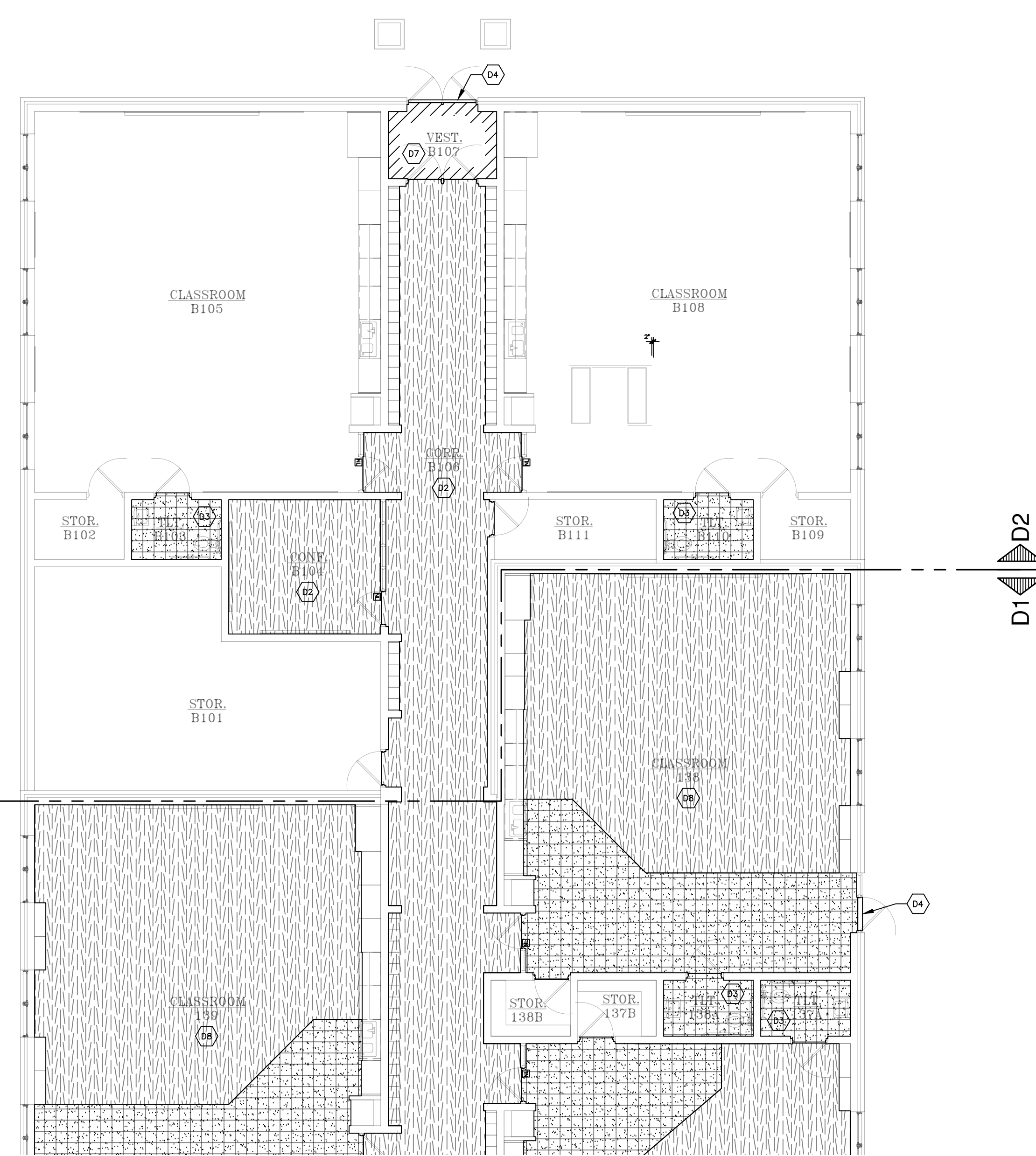

FLOOR PLAN PART "D2" - DEMOLITION



SCALE:

GENERAL DEMOLITION NOTES

REMOVE EX'G ASSEMBLIES TO THE EXTENT REQUIRED FOR THE INSTALLATION OF NEW WORK, AND TO ALLOW FOR CONNECTION OF NEW WORK TO EX'G ADJACENT CONSTRUCTION. KEYED DEMOLITION NOTES ARE GENERAL IN NATURE. ALL EX'G CONDITIONS ARE TO BE FIELD VERIFIED. CONTRACTOR SHALL MAKE NECESSARY ADJUSTMENTS TO DEMOLITION AS REQ'D TO ACHIEVE THE OVERALL DESIGN INTENT.

CONTRACTOR SHALL SALVAGE AND REMOVE EX'G. NIGHT-LOCK DEVICES FOR REINSTALLATION, WHERE PRESENT IN ROOMS SUBJECT TO FLOORING REMOVAL.

CONTRACTOR SHALL REMOVE EX'G FLOORING AND WALL BASE FINISHES AND TRANSITIONS AS REQ'D TO ALLOW FOR THE INSTALLATION OF NEW FINISHES AND TRANSITIONS AS NOTED.

KEYED DEMOLITION NOTES

- D1 REMOVE EX'G. CERAMIC TILE, WALL BASE, AND ACCESSORY TRANSITIONS. EX'G. MUD SET SUB-BASE (IF ANY) TO REMAIN.
- D2 REMOVE EX'G. SHEET CARPETING, RESILIENT WALL BASE, AND ACCESSORY TRANSITIONS.
- D3 REMOVE EX'G. VCT, RESILIENT WALL BASE, AND ACCESSORY TRANSITIONS.
- D4 REMOVE EX'G. THRESHOLD.
- D5 REMOVE EX'G. CERAMIC FLOOR TILE AND ACCESSORY TRANSITIONS. EX'G. CERAMIC WALL BASE AND WAINSCOT TO REMAIN. EX'G. MUD SET SUB-BASE (IF ANY) TO REMAIN.
- D6 REMOVE EX'G. CERAMIC FLOOR TILE AND ACCESSORY TRANSITIONS. EX'G. MUD SET SUB-BASE (IF ANY) TO REMAIN.
- D7 REMOVE EX'G. CERAMIC FLOOR TILE AND ACCESSORY TRANSITIONS, AND RESILIENT WALL BASE. MUD-SET (IF ANY) TO REMAIN.
- D8 REMOVE EX'G. SHEET CARPETING, VCT, RESILIENT WALL BASE, AND ACCESSORY TRANSITIONS.
- D9 REMOVE EX'G. CERAMIC FLOOR TILE AND COVE BASE, AND ACCESSORY TRANSITIONS. EX'G. CERAMIC WAINSCOT ABOVE COVE BASE TO REMAIN. EX'G. MUD SET SUB-BASE (IF ANY) TO REMAIN.
- D10 SALVAGE AND REMOVE EX'G. ALUMINUM THRESHOLD FOR REINSTALLATION AFTER NEW FLOORING.
- D11 SALVAGE AND REMOVE EX'G. COMPOSITE WALL ANGLE FOR REINSTALLATION AFTER NEW FLOORING. REMOVE EX'G. CERAMIC FLOOR TILE AND BASE. EX'G. MUD SET SUB-BASE (IF ANY) TO REMAIN.

FLOORING DEMOLITION LEGEND

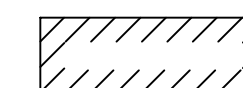
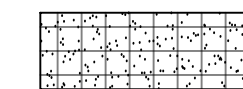
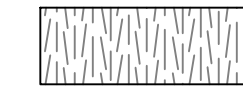
-  REMOVE CERAMIC TILE AND BASE - SEE KEYNOTES FOR SPECIFIC INSTRUCTIONS.
-  REMOVE VCT AND BASE - SEE KEYNOTES FOR SPECIFIC INSTRUCTIONS.
-  REMOVE SHEET CARPET AND BASE - SEE KEYNOTES FOR SPECIFIC INSTRUCTIONS.

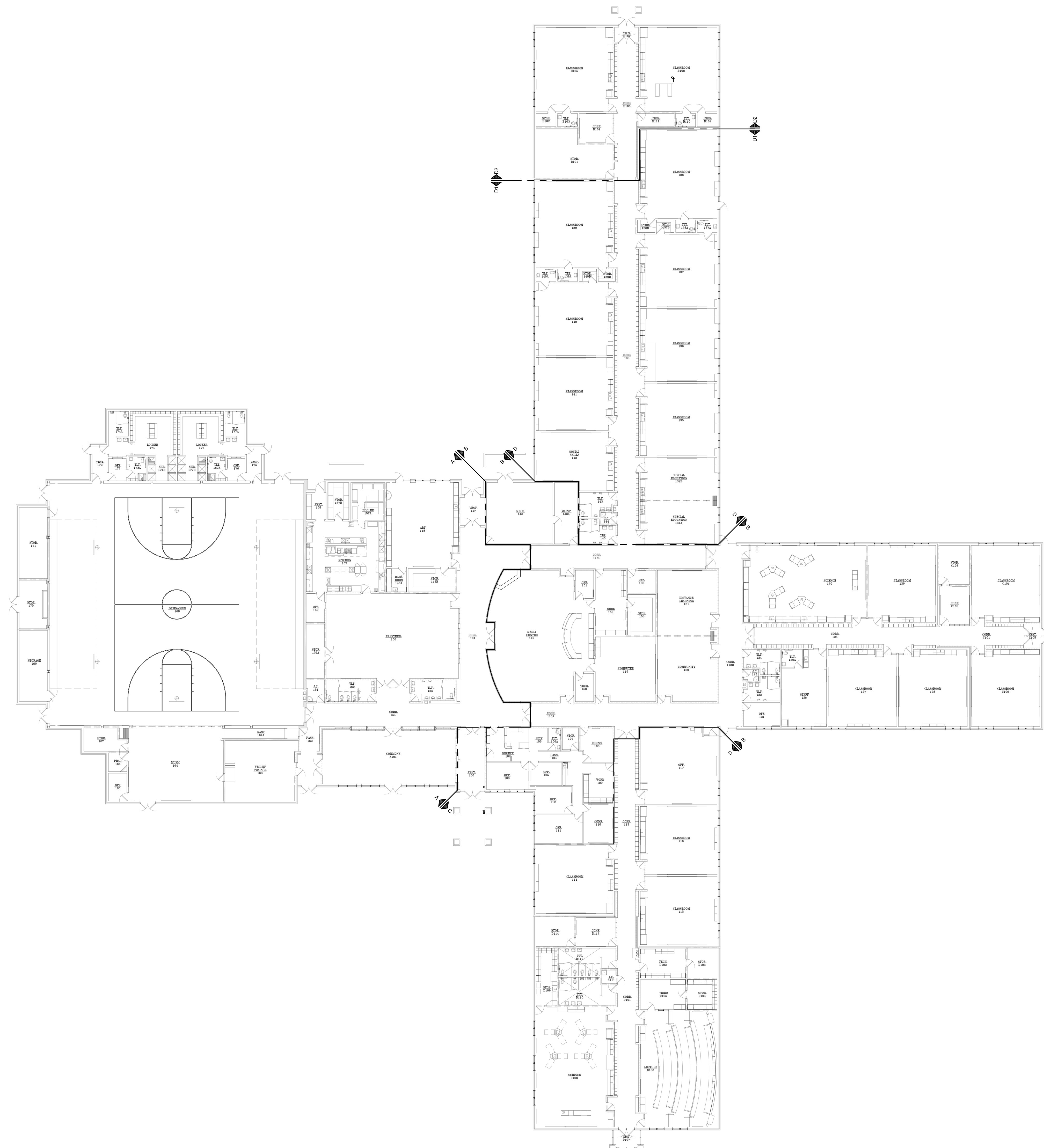

COMPOSITE FLOOR PLAN
 SCALE: 1" = 20'-0"

FIRE WALL LEGEND

- 2 hr. FIRE-RATED FIRE WALL.
- 1 hr. FIRE-RATED AREA SEPARATION FIRE BARRIER.
- 1 hr. FIRE-RATED CORRIDOR FIRE PARTITION.

FLOOR FINISH SCHEDULE

ROOM NO.	ROOM NAME	FLOOR MAT.	WALL BASE	REMARKS	ROOM NO.	ROOM NAME	FLOOR MAT.	WALL BASE	REMARKS
100	VESTIBULE	GT-1 SEE NOTE 6	CB-1	SEE NOTE 1	A101	COMMONS	GT-1 SEE NOTE 6	CB-1	
101	CORRIDOR	GT-1 SEE NOTE 6	CB-1	SEE NOTE 1	B101	STORAGE	ETR (VGT)	ETR (V)	
102	RECEPTION PASSAGE	TC	4" V	SEE NOTES 1 AND 2	B102	STORAGE	ETR (VGT)	ETR (V)	
103	OFFICE	TC	4" V	SEE NOTE 2	B103	TOILET	GT-2 GT-2/CB-2 w/ 15-6 COVE SEE NOTE 15	4" V	SEE NOTE 2
104	PASSAGE	TC	4" V	SEE NOTE 1	B104	CONFERENCE	TC	4" V	SEE NOTE 2
105	OFFICE	TC	4" V	SEE NOTE 2	B105	CLASSROOM	ETR (LVT)	ETR (V)	
106	SICK	VGT	4" V		B107	VESTIBULE	GT-1 SEE NOTE 19	CB-1	
106A	TOILET	GT-2 GT-2/CB-2 w/ 15-6 COVE SEE NOTE 15	4" V		B108	CLASSROOM	ETR (LVT)	ETR (V)	
107	STORAGE	ETR (VGT)	ETR (V)		B109	STORAGE	ETR (VGT)	ETR (V)	
108	COUNSELING	TC	4" V	SEE NOTE 2	B110	TOILET	GT-2 GT-2/CB-2 w/ 15-6 COVE SEE NOTE 15	4" V	
109	WORK	VGT	4" V	SEE NOTE 2	B111	STORAGE	ETR (VGT)	ETR (V)	
110	CONFERENCE	TC	4" V	SEE NOTE 2	C102	CONFERENCE	TC	4" V	SEE NOTE 2
111	OFFICE	TC	4" V	SEE NOTE 2	C103	STORAGE	ETR (VGT)	ETR (V)	
112	OFFICE	TC	4" V	SEE NOTE 2	C104	CLASSROOM	TC	4" V	SEE NOTE 2
113	CORRIDOR	TC/GT-1 SEE NOTE 3	4" V		C105	VESTIBULE	GT-1 SEE NOTE 19	CB-1	
114	CLASSROOM	TC	4" V	SEE NOTE 2	C106	CLASSROOM	TC	4" V	SEE NOTE 2
115	CLASSROOM	TC	4" V	SEE NOTE 2	D102	TECHNOLOGY	TC	4" V	
116	CLASSROOM	TC	4" V	SEE NOTE 2	D103	STORAGE	ETR (VGT)	ETR (V)	
117	OFFICE	TC	4" V	SEE NOTE 2	D104	STORAGE	ETR (VGT)	ETR (V)	
118	CORRIDOR	TC/GT-1 SEE NOTE 3	4" V		D105	VIDEO	TC	4" V	
118B	CORRIDOR	TC/GT-1 SEE NOTE 3	4" V		D106	LECTURE	TC	4" V	SEE NOTE 2
119	COMPUTER	TC	4" V	SEE NOTE 2	D107	VESTIBULE	GT-1 SEE NOTE 19	CB-1	
120	COMMUNITY	TC	4" V	SEE NOTE 2	D108	SCIENCE	VGT	4" V	SEE NOTE 2 AND 11
121	OFFICE	TC	4" V	SEE NOTE 2	D109	STORAGE	VGT	4" V	
122	TOILET	GT-2 GT-2/CB-2 w/ 15-6 COVE SEE NOTE 15	4" V		D110	TOILET	GT-2 ETR (GT)	SEE NOTE 12	
123	JANITOR'S CLOSET	ETR (G)	ETR (V)		D111	JANITOR'S CLOSET	ETR (G)	ETR (V)	
124	TOILET	GT-2 GT-2/CB-2 w/ 15-6 COVE SEE NOTE 15	4" V		D112	TOILET	GT-2 ETR (GT)	SEE NOTE 12	
125	CORRIDOR	TC/GT-1 SEE NOTE 3	4" V		D113	CONFERENCE	TC	4" V	SEE NOTE 2
125A	CORRIDOR	TC/GT-1 SEE NOTE 3	4" V						
126	STAFF	TC	4" V	SEE NOTE 2					
126A	TOILET	GT-2 GT-2/CB-2 w/ 15-6 COVE SEE NOTE 15	4" V						
127	CLASSROOM	TC	4" V	SEE NOTE 2					
128	CLASSROOM	TC	4" V	SEE NOTE 2					
129	CLASSROOM	TC	4" V	SEE NOTE 2					
130	SCIENCE	VGT	4" V	SEE NOTE 2 AND 4					
131	DISTANCE LEARNING	TC	4" V	SEE NOTE 2					
132	OFFICE	TC	4" V	SEE NOTE 2					
132C	CORRIDOR	TC	4" V	SEE NOTE 2					
133	CORRIDOR	TC/GT-1 SEE NOTE 3	4" V						
133A	CORRIDOR	TC/GT-1 SEE NOTE 3	4" V						
134A	SPECIAL EDUCATION	TC/VGT SEE NOTE 3	4" V	SEE NOTE 2					
134B	SPECIAL EDUCATION	TC/VGT SEE NOTE 3	4" V	SEE NOTE 2					
135	CLASSROOM	TC/VGT SEE NOTE 3	4" V	SEE NOTE 2					
136	CLASSROOM	TC/VGT SEE NOTE 3	4" V	SEE NOTE 2					
137	CLASSROOM	TC/VGT SEE NOTE 3	4" V	SEE NOTE 2					
137A	TOILET	GT-2 GT-2/CB-2 w/ 15-6 COVE SEE NOTE 15	4" V						
137B	STORAGE	ETR (VGT)	ETR (V)						
138	CLASSROOM	TC/VGT SEE NOTE 3	4" V	SEE NOTE 2					
138A	TOILET	GT-2 GT-2/CB-2 w/ 15-6 COVE SEE NOTE 15	4" V						
139	STORAGE	ETR (VGT)	ETR (V)						
139A	CLASSROOM	TC/VGT SEE NOTE 3	4" V	SEE NOTE 2					
139A	TOILET	GT-2 GT-2/CB-2 w/ 15-6 COVE SEE NOTE 15	4" V						
139B	STORAGE	ETR (VGT)	ETR (V)						
140	CLASSROOM	TC/VGT SEE NOTE 3	4" V	SEE NOTE 2					
140A	TOILET	GT-2 GT-2/CB-2 w/ 15-6 COVE SEE NOTE 15	4" V						
140B	STORAGE	ETR (VGT)	ETR (V)						
141	CLASSROOM	TC/VGT SEE NOTE 3	4" V	SEE NOTE 2					
142	SOCIAL SKILLS	TC/VGT SEE NOTE 3	4" V	SEE NOTE 2					
143	TOILET	GT-2 GT-2/CB-2 w/ 15-6 COVE SEE NOTE 15	4" V						
144	JANITOR'S CLOSET	ETR (G)	ETR (V)						
145	TOILET	GT-2 GT-2/CB-2 w/ 15-6 COVE SEE NOTE 15	4" V						
146	JANITOR'S CLOSET	ETR (G)	ETR (V)						
146A	JANITOR'S CLOSET	ETR (G)	ETR (V)						
147	VESTIBULE	GT-1 SEE NOTE 6	CB-1						
148	ART	VGT	4" V						
148A	DARKROOM	VGT	4" V						
148B	STORAGE	ETR (VGT)	ETR (V)						
149	MEDIA CENTER	TC	4" V	SEE NOTE 2, 7 AND 8					
150	TECHNOLOGY	ETR (VGT)	ETR (V)						
151	OFFICE	TC	4" V						
152	WORK	TC	4" V	SEE NOTE 2					
153	STORAGE	ETR (VGT)	ETR (V)						
155	TOILET	GT-2 GT-2 w/ 15-6 COVE	4" V						
156	CAFETERIA	GT-1 SEE NOTE 6	CB-1						
156A	STORAGE	ETR (VGT)	ETR (V)						
157	KITCHEN	ETR (GT)	ETR (GT)						
157A	COOLER	ETR (GT)	ETR (NONE)						
157B	STORAGE	ETR (VGT)	ETR (V)						
158	VESTIBULE	ETR (NONE)	ETR (NONE)						
159	OFFICE	VGT	4" V						
160	TOILET	GT-2 GT-2 w/ 15-6 COVE	4" V						
161	JANITOR'S CLOSET	ETR (G)	ETR (V)						
163	WEIGHT TRAINING	ETR (VGT)	ETR (V)						
164	MUSIC	VGT	4" V						
164A	RAMP	TC	4" V						
165	OFFICE	VGT	4" V						
166	PRACTICE	VGT	4" V						
167	STORAGE	ETR (VGT)	ETR (V)						
168	GYMNASIUM	ETR (WOOD) GT-1 (NOTE 6)	ETR (V) CB-1	SEE NOTE 4					
169	STORAGE	ETR (VGT)	ETR (V)						
170	STORAGE	ETR (VGT)	ETR (V)						
171	STORAGE	ETR (VGT)	ETR (V)						
172	VESTIBULE	ETR (GT)	ETR (GT)						
173	OFFICE	ETR (GT)	ETR (GT)						
173A	TOILET	ETR (GT)	ETR (GT)						
174	LOCKER ROOM	ETR (GT)	ETR (GT)						
174A	TOILET	ETR (GT)	ETR (GT)						
174B	SHOWER	ETR (GT)	ETR (GT)						
175	VESTIBULE	ETR (GT)	ETR (GT)						
176	OFFICE	ETR (GT)	ETR (GT)						
176A	TOILET	ETR (GT)	ETR (GT)						
177	LOCKER ROOM	ETR (GT)	ETR (GT)						
177A	TOILET	ETR (GT)	ETR (GT)						
177B	SHOWER	ETR (GT)	ETR (GT)						

ROOM FINISH SCHEDULE ABBREVIATIONS:
 C CONCRETE
 CB-# CERAMIC BASE (SEE SPECIFICATION FOR TYPE AND SIZE)
 GT-# CERAMIC TILE (SEE SPECIFICATION FOR TYPE AND SIZE)
 E EX EXIS EXISTING
 ETR EXISTING TO REMAIN
 LVT LUXURY VINYL TILE
 RA# RESILIENT ATHLETIC FLOORING
 TC TILE CARPETING
 V VINYL (RESILIENT) WALL BASE
 VGT VINYL (RESILIENT) COMPOSITE TILE
 WD WOOD

SCHEDULE CONVENTIONS - EXAMPLES:
 FLOORING = SCHEDULED MATERIAL OR FINISH
 ETR (VGT) = EXISTING TO REMAIN - RESILIENT COMPOSITE TILE
 TC = TILE CARPETING (NEW)

FLOORING MATERIAL TRANSITIONS / DIVIDERS / THRESHOLDS:
 TR-# RESILIENT TRANSITION - SEE SPECIFICATION SECTION 09 65 15.
 TR-1 CARPET TO VGT
 TR-2 CARPET TO EXPOSED CONCRETE SLAB
 TR-3 NOT USED
 TR-4 VGT TO SUBFLOOR
 TR-5 CARPET TO LVT
 RN-# RESILIENT NOSING - SEE SPECIFICATION SECTION 09 65 15.
 RN-1 RESILIENT NOSING
 TS-# SCHLUTER TRANSITION - SEE SPECIFICATION SECTION 09 30 00.
 TS-1 SHINE STRAIGHT SCHLUTER
 TS-2 RENO-RAMP SLOPED SCHLUTER
 TS-3 RENO-U SLOPE SCHLUTER
 TS-4 RENO-T EDGE PROTECTION SCHLUTER
 TS-5 DECO STRAIGHT SCHLUTER
 TS-6 COVERED BASE SCHLUTER
 TH-# THRESHOLD - SEE SPECIFICATION SECTION 09 70 00.
 TH-1 HALF SADDLE THRESHOLD
 TH-2 SADDLE THRESHOLD

KEYED ROOM FINISH NOTES (SEE SCHEDULE ABOVE):
 1. COORDINATE REMOVAL AND INSTALLATION OF FLOORING AND WALL BASE WITH REMODELING BEING COMPLETED UNDER SEPARATE CONTRACT.
 2. REMOVE DOOR SECURITY HARDWARE (NIGHTLOCK) AS REQUIRED TO REMOVE AND REPLACE FLOORING AND REINSTALL.
 3. GT-1 (18" x 18") FLOORING AT DRINKING FOUNTAIN ONLY.
 4. REMOVE SCIENCE TABLES ATTACHED TO SCIENCE ISLANDS AS REQUIRED TO EXTEND VGT THROUGH UNDER SUPPORTING LEGS. REINSTALL AFTER FLOORING INSTALLATION.
 5. VGT FLOORING AT SINK AS INDICATED. EXTEND 3'-0" FROM TOE KICK x 1'-0" WIDE - DIMENSIONS TYPICAL (SEE PLAN - SPECIAL EDUCATION 134B).
 6. GT-1 FLOORING IN 6x6, 12x12, AND 18x18. SEE PLAN FOR PATTERN.
 7. INSTALL FLOORING IN FLOOR JUNCTION BOX COVERS. FILED VERIFY QUANTITY.
 8. REMOVE FLOOR DATA BOX COVERS AS REQUIRED TO REMOVE AND REPLACE FLOORING AND REINSTALL. FILED VERIFY QUANTITY.
 9. REPAIR EXISTING FLOOR TILE ADJACENT TO ENTRY DOORS / DRINKING FOUNTAIN. REMOVE EXISTING SADDLE EXPANSION COVER AS REQUIRED TO REMOVE AND REPLACE FLOOR TILE, AND REINSTALL.
 10. GT-1 18x18 ONLY.
 11. REMOVE PLUMBING ACCESS PANELS FROM STUDENT ISLANDS (4 LOCATIONS) AS REQUIRED TO EXTEND VGT THROUGH UNDER PLUMBING CHASE. REINSTALL AFTER FLOORING INSTALLATION.
 12. PROTECT EXISTING GT COVE BASE AND WAINSCOT TO REMAIN. INSTALL NEW GT FLOOR TILE ONLY.
 13. WALL BASE TO CONSIST OF GT-2 TILE BASE COURSE WITH CB-2 TOP COURSE. TOTAL BASE HEIGHT 6'-2".

ANTHONY P. ESSON
 ARCHITECT
 PO BOX 479
 GAYLORD, MICHIGAN
 (989) 732-0585
 TELEPHONE:

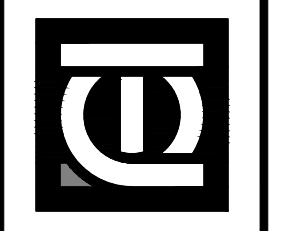

COMPOSITE FLOOR PLAN
ROOM FINISH SCHEDULE

PROJECT TITLE
 PROPOSED FLOORING REPLACEMENT FOR:
BOZYOYNE FALLS PUBLIC SCHOOL
 BOZYOYNE FALLS, MICHIGAN

PROJECT NO.
 304-26A

DATE
 JUNE 5, 2025

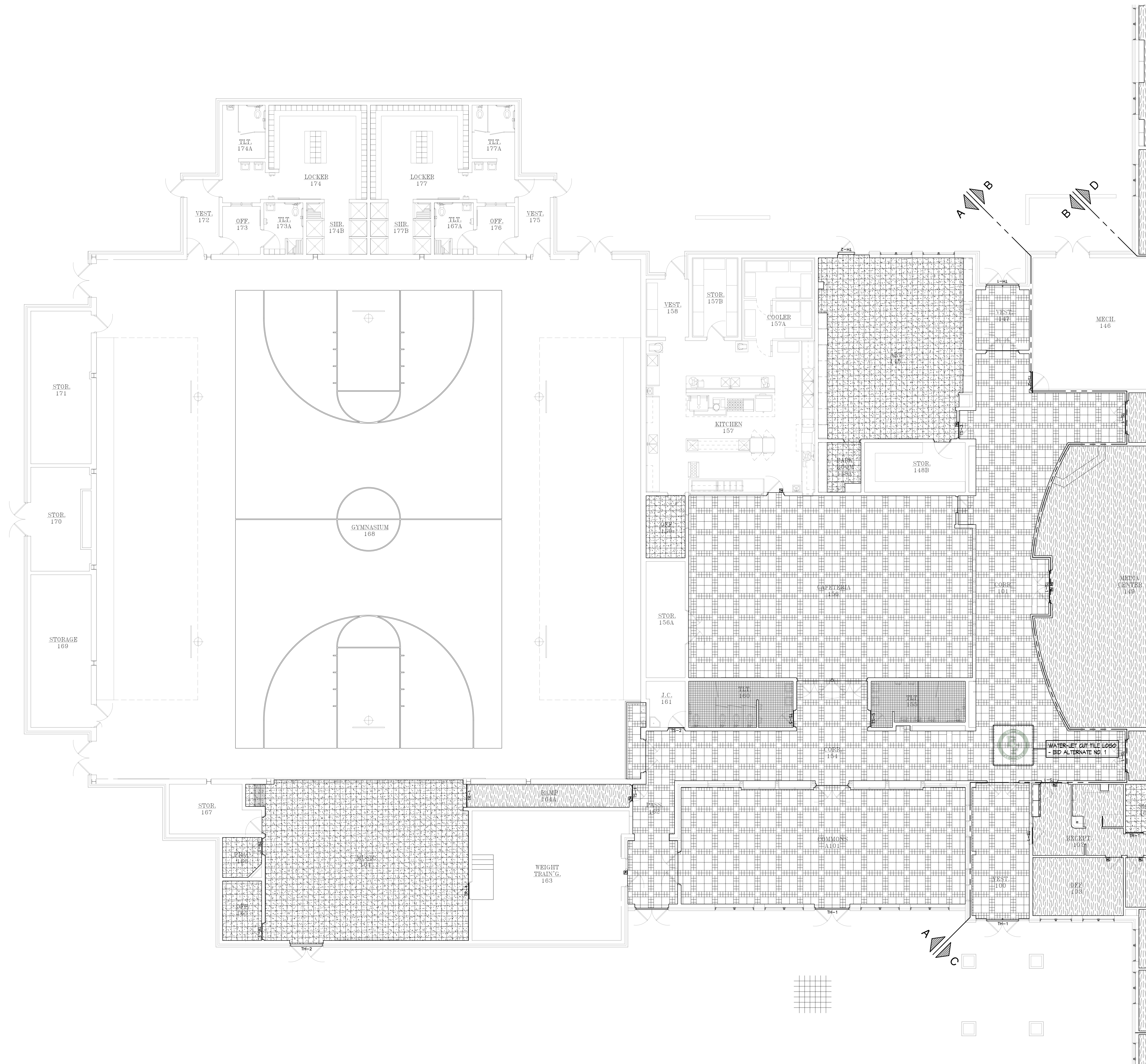

SHEET
A0.1



FLOOR PLAN PART "A" - NEW WORK
 SCALE: 1/8" = 1'-0"

FLOORING MATERIAL QUANTITIES (APPROX.)

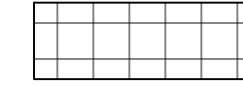
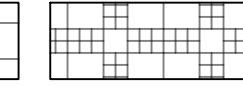
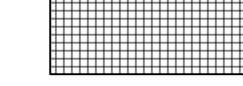
FLOORING QUANTITIES LISTED ARE PROJECTED FLOOR AREA AND DO NOT INCLUDE VERTICAL RISERS OR SLOPE CORRECTIONS. CONTRACTOR SHALL FIELD VERIFY QUANTITIES AND SHALL PROVIDE ALL LABOR AND MATERIAL FOR A COMPLETE FLOORING REPLACEMENT.

-  5,820± sq ft TOTAL AREA - PORCELAIN TILE 6x6, 12x12 OR 12x18 w/ MATCHING BASE - SEE PLAN FOR PATTERN
-  16,451± sq ft TOTAL AREA - CERAMIC TILE 4x4 w/ MATCHING BASE
-  5,670± sq ft TOTAL AREA - VCT w/ 4" RESILIENT BASE
-  33,148± sq ft (29,823± sq ft) CARPET TILE w/ 4" RESILIENT BASE

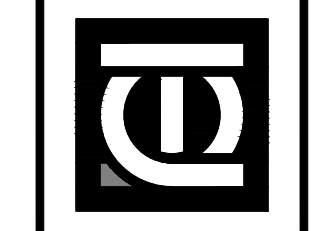



FLOOR PLAN PART "B" - NEW WORK
 SCALE: 1/8" = 1'-0"

FLOORING MATERIAL QUANTITIES (APPROX.)

FLOORING QUANTITIES LISTED ARE PROJECTED FLOOR AREA AND DO NOT INCLUDE VERTICAL RISERS OR SLOPE CORRECTIONS. CONTRACTOR SHALL FIELD VERIFY QUANTITIES AND SHALL PROVIDE ALL LABOR AND MATERIAL FOR A COMPLETE FLOORING REPLACEMENT.

	5,920± sq TOTAL AREA - PORCELAIN TILE 6x6, 12x12 OR 18x18 w/ MATCHING BASE - SEE PLAN FOR PATTERN
	16,451± sq TOTAL AREA - CERAMIC TILE 4x4 w/ MATCHING BASE
	5,670± sq TOTAL AREA - VCT w/ 4" RESILIENT BASE
	33,144 sq (29,825± sq) CARPET TILE w/ 4" RESILIENT BASE

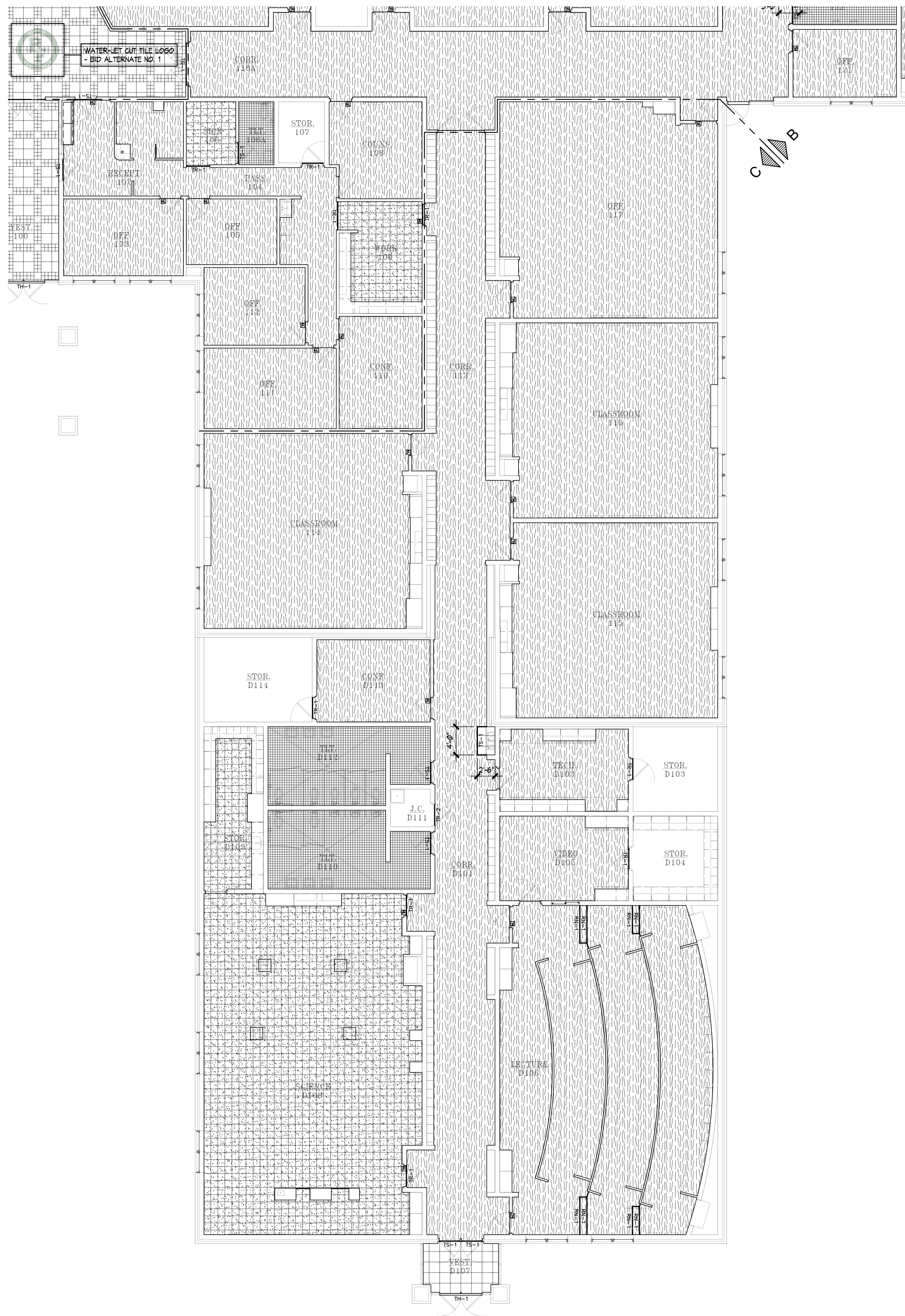



FLOOR PLAN PART "C" - NEW WORK

SCALE: $\frac{1}{8}'' = 1'-0''$

FLOORING MATERIAL QUANTITIES (APPROX.)

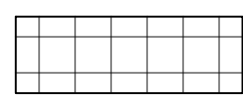
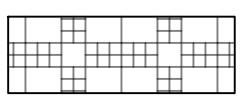
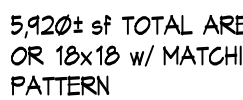
FLOORING QUANTITIES LISTED ARE PROJECTED FLOOR AREA AND DO NOT INCLUDE VERTICAL RISERS OR SLOPE CORRECTIONS. CONTRACTOR SHALL FIELD VERIFY QUANTITIES AND SHALL PROVIDE ALL LABOR AND MATERIAL FOR A COMPLETE FLOORING REPLACEMENT.

-  5,120± sq TOTAL AREA - PORCELAIN TILE 6x6, 12x12 OR 18x18 w/ MATCHING BASE - SEE PLAN FOR PATTERN
-  1645± sq TOTAL AREA - CERAMIC TILE 4x4 w/ MATCHING BASE
-  5,670± sq TOTAL AREA - VCT w/ 4" RESILIENT BASE
-  33,144 sq (29,829± sq) CARPET TILE w/ 4" RESILIENT BASE

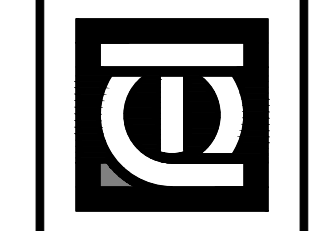

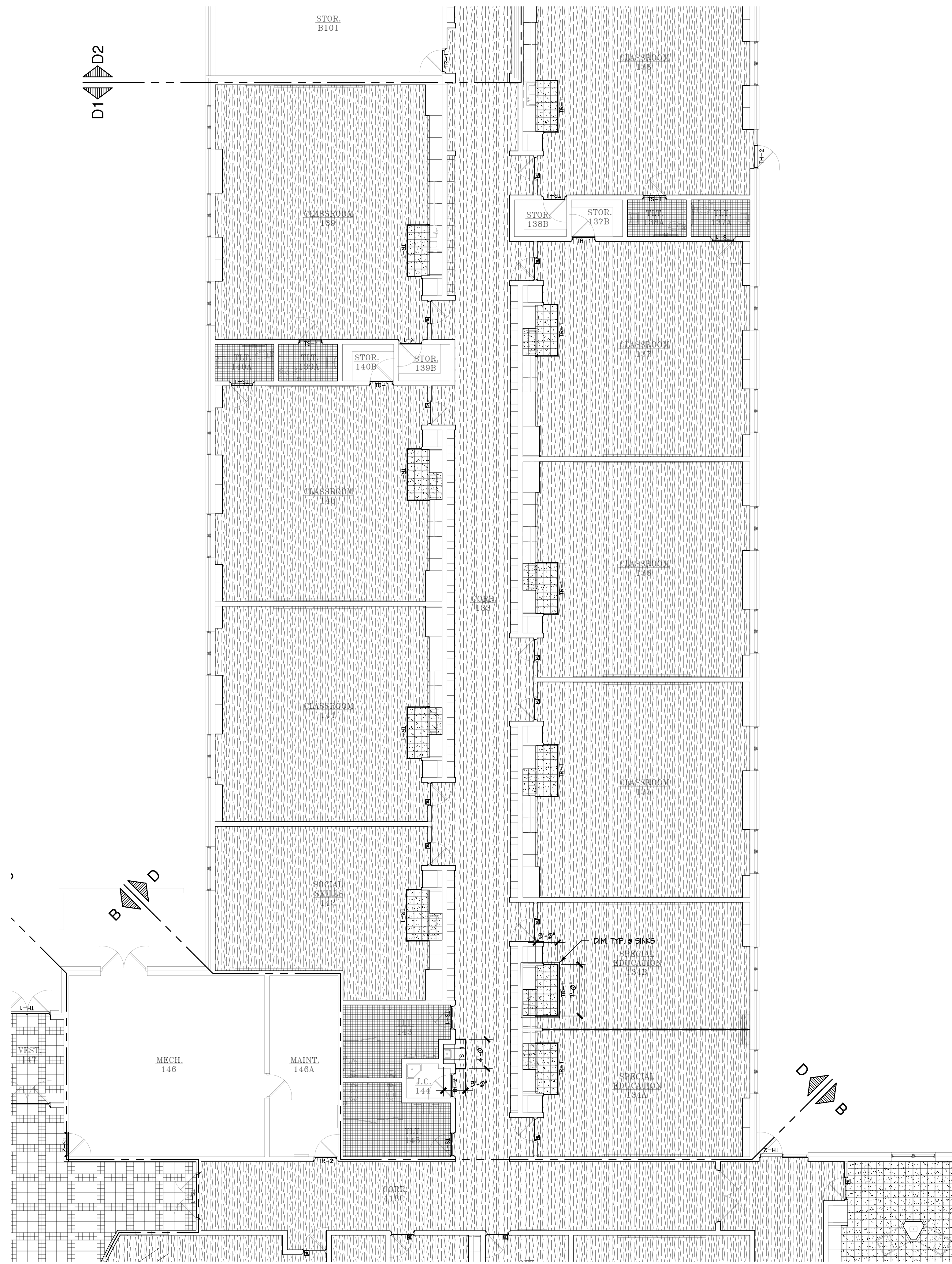

FLOOR PLAN PART "D1" - NEW WORK
 NORTH
 SCALE: 1/8" = 1'-0"

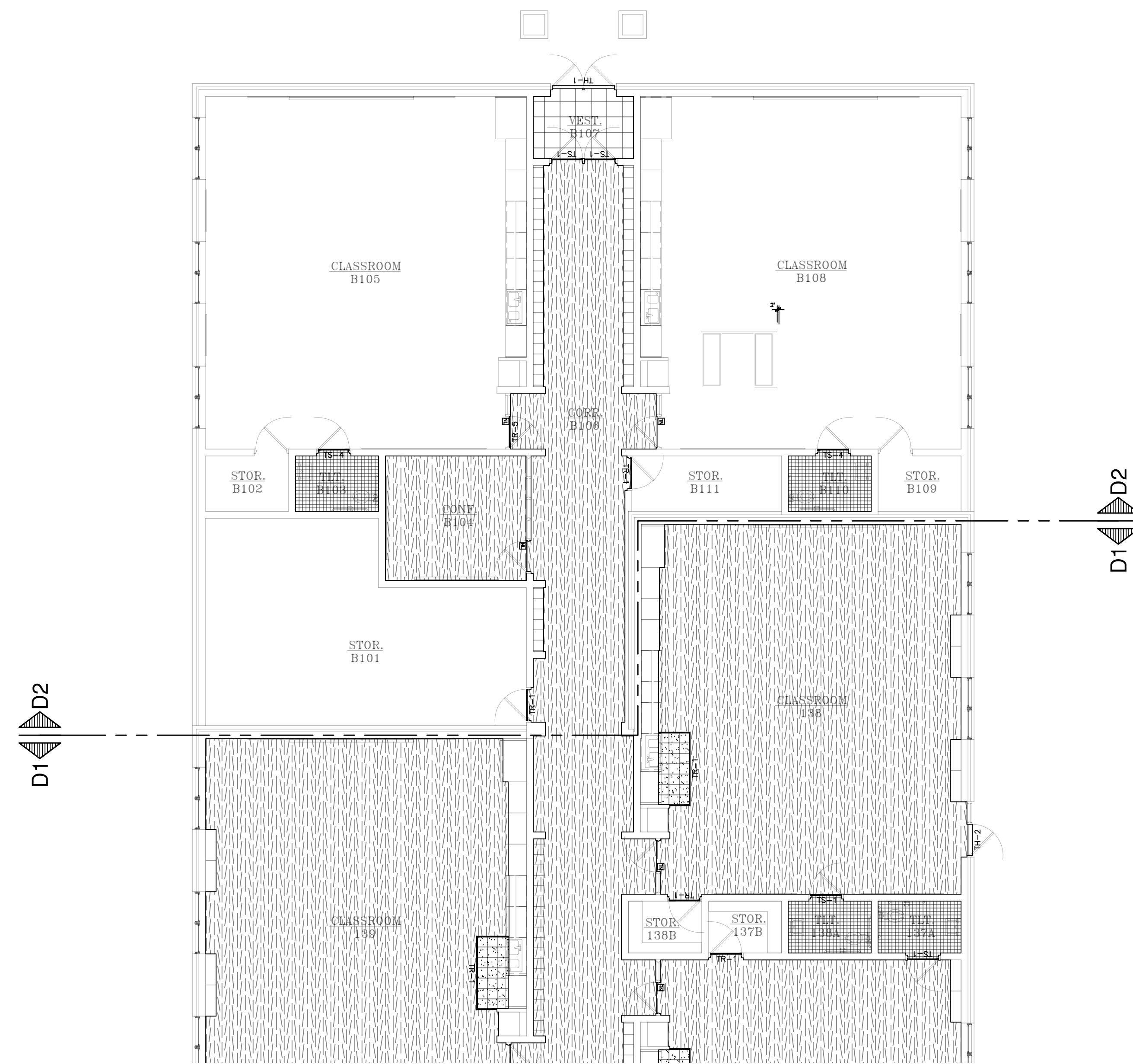

FLOOR PLAN PART "D2" - NEW WORK
 NORTH
 SCALE:

FLOORING MATERIAL QUANTITIES (APPROX.)

FLOORING QUANTITIES LISTED ARE PROJECTED FLOOR AREA AND DO NOT INCLUDE VERTICAL RISERS OR SLOPE CORRECTIONS. CONTRACTOR SHALL FIELD VERIFY QUANTITIES AND SHALL PROVIDE ALL LABOR AND MATERIAL FOR A COMPLETE FLOORING REPLACEMENT.

	5,120± sq TOTAL AREA - PORCELAIN TILE 6x6, 12x12 OR 18x18 w/ MATCHING BASE - SEE PLAN FOR PATTERN
	16,45± sq TOTAL AREA - CERAMIC TILE 4x4 w/ MATCHING BASE
	5,670± sq TOTAL AREA - VCT w/ 4" RESILIENT BASE
	33,14± sq (29,825± sq) CARPET TILE w/ 4" RESILIENT BASE