

Midland ESA

Phased Sequencing Plan

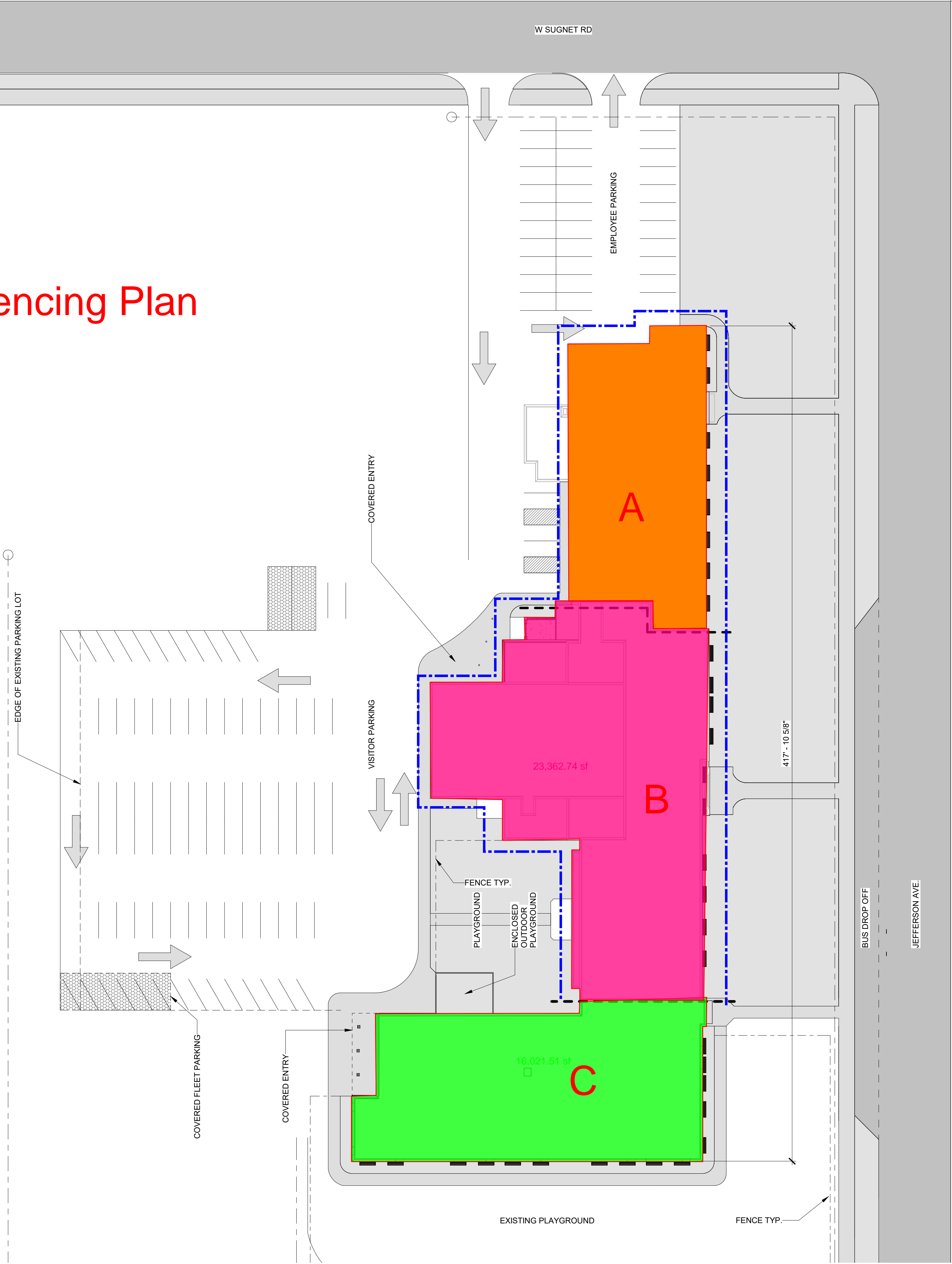

TRC Anticipated Work Sequencing Plan

- 1. Area C-New Addition  
Start Fall 2023
- Existing Building Improvements (flexible)  
Roofing Improvements  
Exterior Window Replacements  
Masonry Restoration
- 2. Area B-Lower Level  
Start Summer 2024
- 3. Area B-2nd Level  
Start Summer/Early Fall 2024
- 4. Area A-2nd Level  
Start Spring 2025
- 5. Area A-Lower Level  
Start Summer 2025

Overall completion est. Fall 2025

New Fire Suppression system & installation to follow overall sequencing schedule above.

New Addition(Area C) will be complete & turned over to owner prior to commencing renovation stages.

Each Renovation area will be complete demo to finishes and turned over for complete owner occupancy before moving to next renovation phase.

NOT FOR CONSTRUCTION  
PRELIMINARY

DESIGN DEVELOPMENT		05/15/23
NO.	REVISION	DATE

WTA ARCHITECTS

100 S Jefferson Ave, Suite 601  
Saginaw, Michigan 48607  
989 752 8107

WTAARCH.COM  
COPYRIGHT © 2022

PROJECT TITLE RENOVATION AND ADDITION: MIDLAND COUNTY ESA	
MIDLAND, MICHIGAN	
SHEET TITLE ARCHITECTURAL SITE PLAN	
PROJECT NUMBER 2022006.1	SHEET NUMBER A1.01
PROJECT DATE MAY 15, 2023	
CHECKED BY Checker	